

GROUND FLOOR

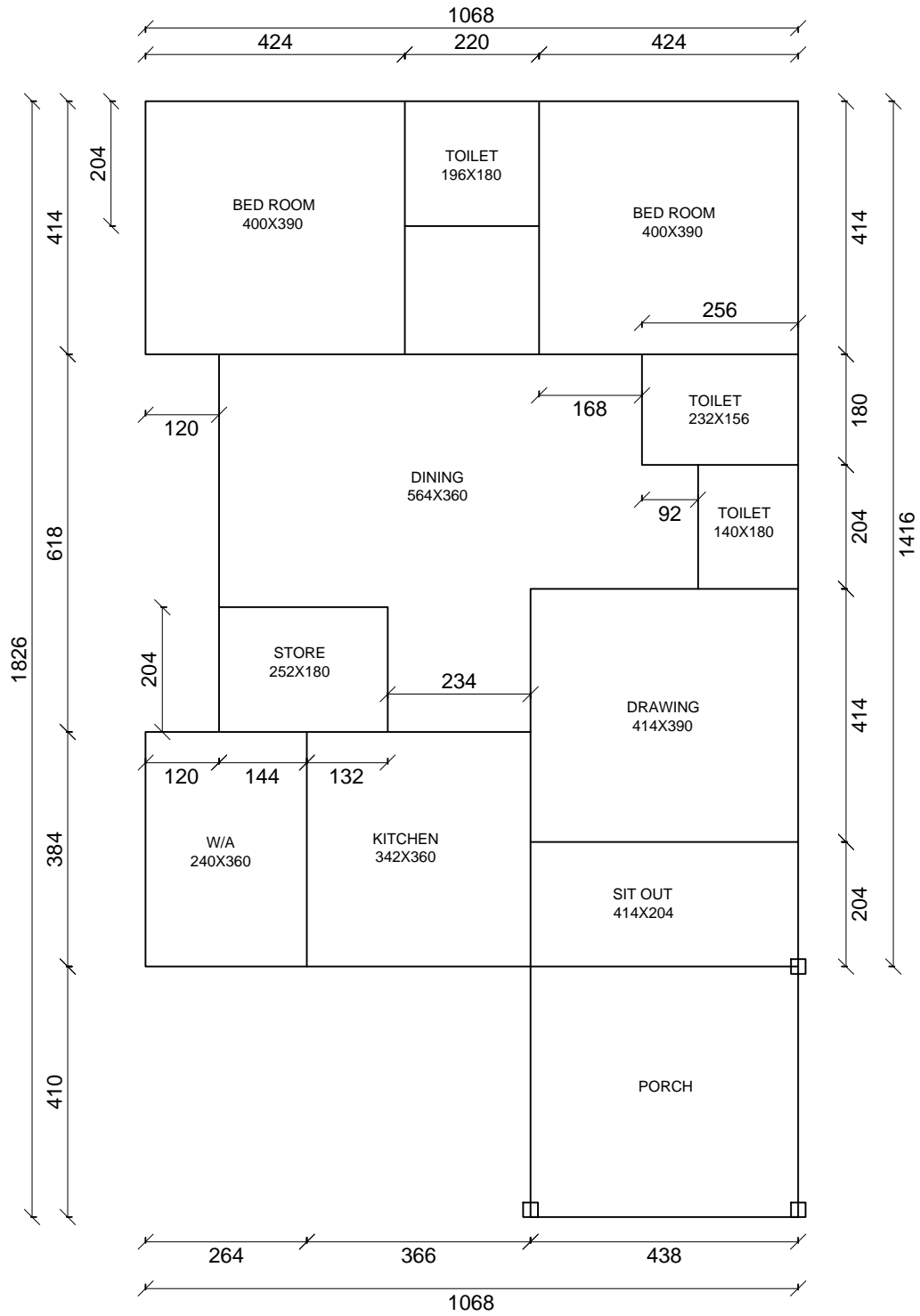

DESIGNED BY
VEEDUM PLANUM
 MANIMALA, KOTTAYAM
 PH: 9447365988
 veedumplanum@gmail.com
 faizalmangalasseril@gmail.com

ALL DIMENSIONS ARE IN CENTIMETERS
 DATE: 20-08-2015

**CENTRE LINE
 DRAWING**

CLIENT:
 SURESH KUMAR
 BHARANIKKAVU
 KOLLAM

AREA STATEMENT:-
 GROUND FLOOR: 1845 SQFT
 FIRST FLOOR: 947 SQFT
 TOTAL AREA : 2792 SQFT

STAIR DETAILS
 TREAD: 26 CM
 RISE: 16.3 CM
 WIDTH : 104 CM